

Crane Components _

Quality in Detail



- › **High-performance** _ the most comprehensive and complete range of hoisting technology products in the world
- › **Mature** _ drive technology for the highest standards
- › **Reliable** _ innovative, efficient control technology

Competence from STAHL CraneSystems _

over 130 years of practical approach and experience

Headquarters and production site in Künzelsau, Germany.



In the R&D department, competent engineers and technicians design innovative, cost-effective solutions.



- 1876** | Company founded by Rafael Stahl
- 1898** | First electric portal crane
- 1903** | First electric pulley block
- 1950** | The world's first portable miniature electric chain hoist
- 1998** | SH wire rope hoist
- 2004** | World innovation: extra short headroom trolley
- 2007** | TDC twin drive concept
- 2008** | STD Vario dual chain hoist



All control technology is installed at STAHL CraneSystems by specialists in accordance with customers' specifications.



Manual assembly of an individual off-standard solution.

1876



1898



1903



1950



1998



2004



2007



2008



Several thousand hoists and other crane components are produced every year at two production locations in Germany.

Qualified staff work with modern technology in the production area.



Modern manufacturing techniques, certified processes and in-depth final inspections guarantee the consistently high quality of the hoists and crane components.

All precision parts, for example gearwheels, drive shafts, are manufactured right in STAHL CraneSystems' own factory.

All over the world, sales partners and customers are trained effectively by specialists from STAHL CraneSystems.

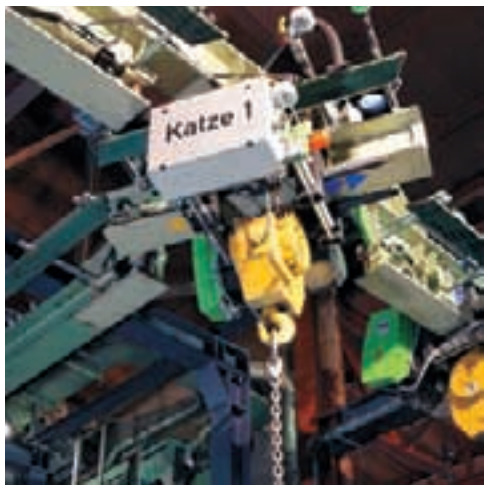



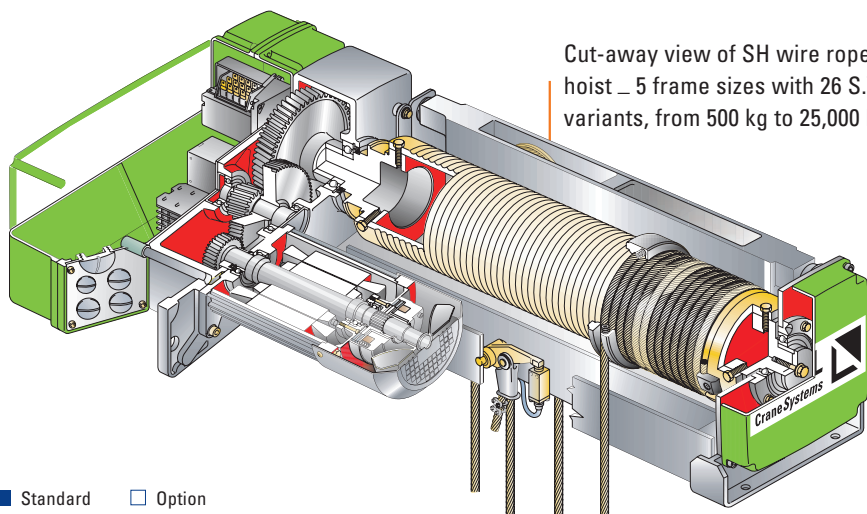

Cut-away view of SH wire rope hoist _ 5 frame sizes with 26 S.W.L. variants, from 500 kg to 25,000 kg.

SH wire rope hoist _ modular system of superlative quality, offering maximum flexibility.



■ Standard □ Option

Type	S.W.L. up to [kg]	Standard reeving	Reeving for true vertical lift	Stationary	Double rail crab OE	Monorail trolleys		
						KE	UE	DKE
SH 3	3,200	■	■	■	■	■	■	■
SH 4	6,300	■	■	■	■	■	■	■
SH 5	12,500	■	■	■	■	■	■	■
SHR 6	16,000	■	■	■	■	■	□	□
SH 6	25,000	■	■	■	■	■	□	□
AS 7	100,000	■	■	■	■	□	□	□
SHW 8	160,000		■	■	■			



AS 7 wire rope hoist _ for the top S.W.L. range up to 100,000 kg.

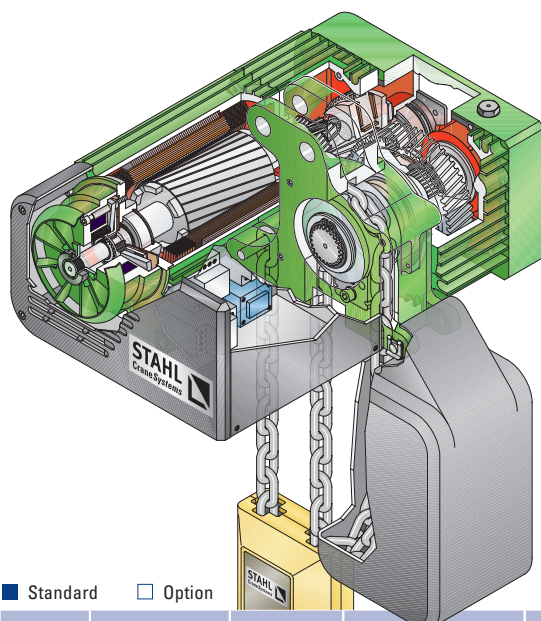

Cut-away view of ST chain hoist _ 13 S.W.L. variants, from 125 kg to 6,300 kg.

ST chain hoist _ standard headroom.



STD dual chain hoist _ absolutely synchronous hoisting motions thanks to a single hoist motor, the load chains run completely in parallel even if the load is unbalanced.

■ Standard □ Option

Type	S.W.L. [kg]	Stationary	Push trolley	Electric trolley	Dual chain hoist	Entertainment hoist	[Extra] Short headroom trolley	Articulated trolley
ST 05	125 – 630	■	■	■	■	■	■	■
ST 10	500 – 1,000	■	■	■	■	■		■
ST 20	1,000 – 2,000	■	■	■	■	■	■	■
ST 30	1,250 – 3,200	■	■	■	■	□	■	■
ST 50	2,500 – 5,000	■	□	■	■	■	■	■
ST 60	3,200 – 6,300	■		■	■	□	□	■





SH 6 wire rope hoist _ safe handling, true vertical lift thanks to two-rope design.



SHW 8 winch _ innovative construction, for the heavy load range from 32,000 kg upwards.



TDC twin drive concept _ doubly safe, for transporting molten metals and similar potentially hazardous goods.

Hoist technology

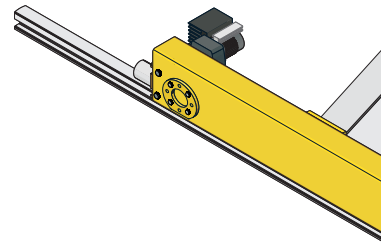

Short headroom trolley _ patented design, headroom reduced by approx. 33 %.



Extra short headroom trolley _ patented design, headroom reduced by over 60 %.

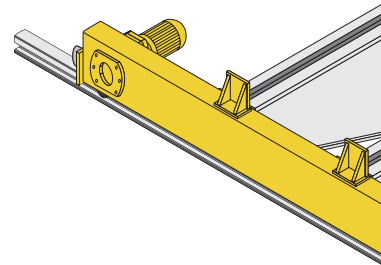

STD Vario dual chain hoist _ with electrically adjustable spacing between the hooks, completely synchronous operation when transporting loads of different lengths.

Drive technology

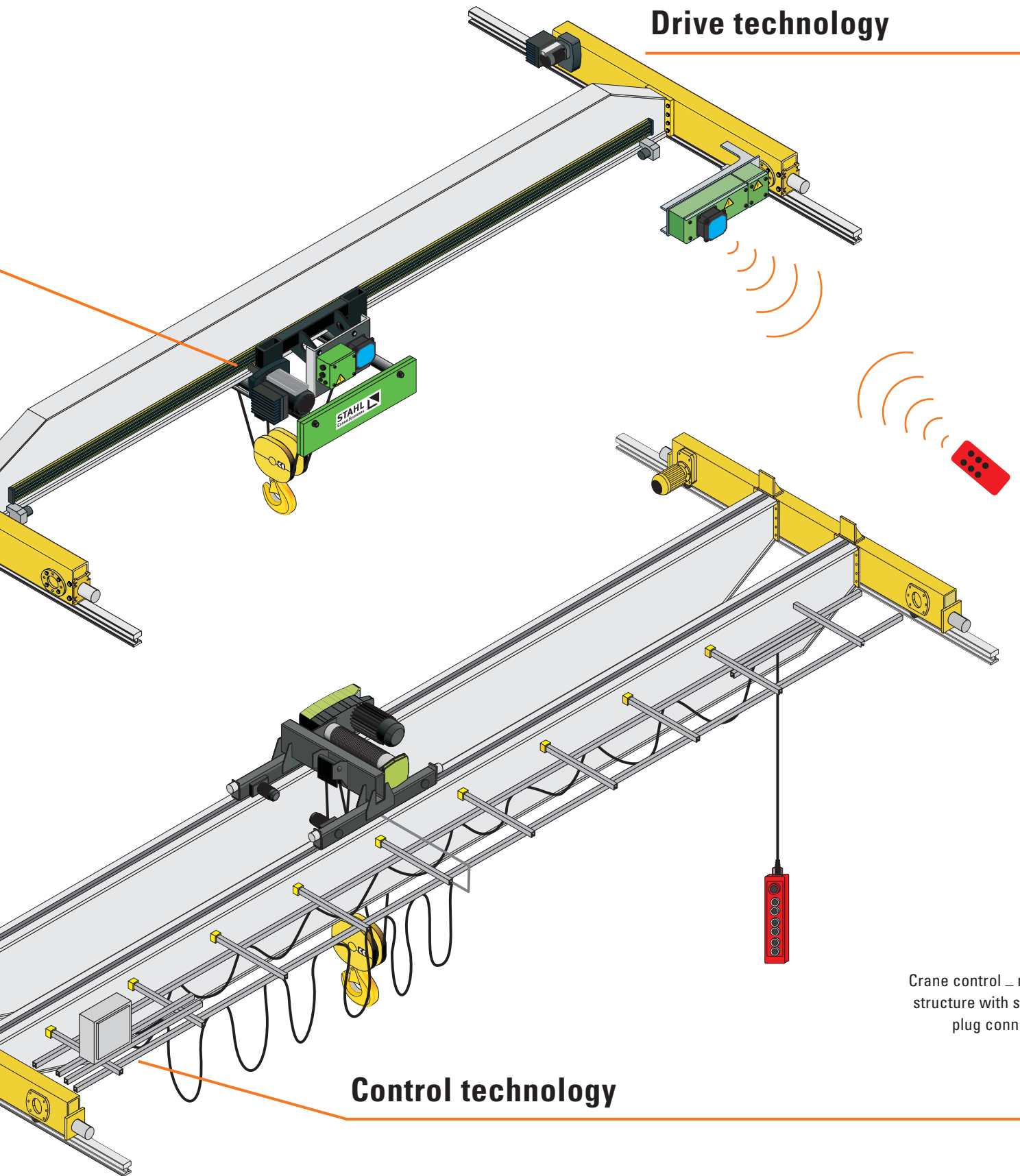

Control technology

Crane control _ modular structure with standard plug connections.

SFD frequency inverter _ for stepless speed control of drives, can be parametrised.

Crane endcarriages _ with 5 different wheel diameters, low-maintenance direct drive.

SF crane travel drives _ low-maintenance drives with two speeds as standard, push-on motor connection.

SR wheel block system _ 6 frame sizes for wheel loads from 5 t to 30 t.

Original spare parts _ available for decades, even after the series has been discontinued.

Conductor line _ cable harness reduced by approx. 80 %, no need for moving cables and cable trolleys.

Load display _ large-format, four-figure, integrated load summation feature monitors the total load on the two hooks.

STH control pendant _ robust, cost-effective, optional load display.

Radio remote control switches _ compact cubix pushbutton control for one-handed operation, micron pushbutton switch with optional signal feedback from crane, spectrum joystick transmitter (from left to right).

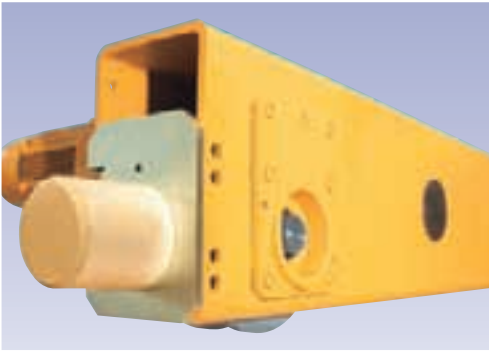

Explosion-protected crane technology – uncompromisingly safe

STAHL CraneSystems is the world market leader for explosion-protected hoist technology, drive technology and control technology.

Application	Category	Protection against	Explosion protection class
Zone 1	II 2 G	Gas	Ex de IIB T4 or Ex de IIC T4
Zone 2	II 3 G	Gas	Exn de A IIB T3
Zone 21	II 2 D	Dust	Ex tD A 21 IP66 T 120°C
Zone 22	II 3 D	Dust	Ex tD A22 IP66 T 120°C



A single girder suspension crane with 1,600 kg S.W.L. is used for transporting components for maintenance work in the outdoor area of a chemical plant.



All hoists from STAHL CraneSystems are available in explosion-protected design, this illustration shows an ST chain hoist.



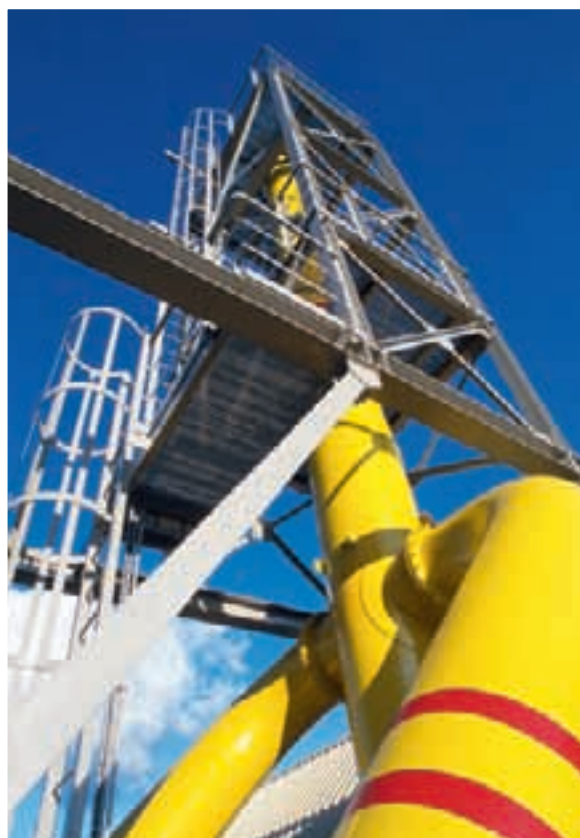

Flameproof cable bushing for connecting Ex e to Ex d enclosure.



The SH ex wire rope hoist, as all hoists from STAHL CraneSystems, complies with all technical, normative and practical requirements stipulated by ATEX.



Protection against sparks in hazardous areas provided by bronze-coated load hooks.

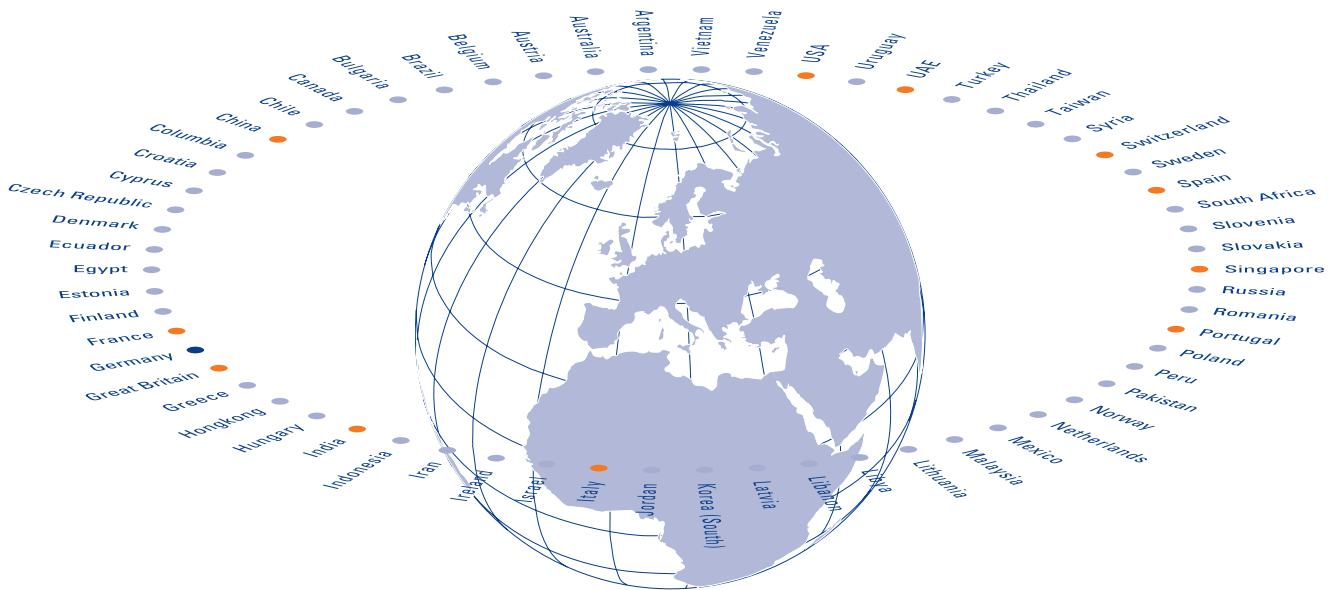

● Headquarters

STAHL CraneSystems GmbH, Daimlerstr. 6, 74653 Künzelsau, Germany, Tel +49 7940 128-0, Fax +49 7940 55665, info@stahlcranes.de

● Subsidiaries

● Sales partners

You will find the addresses of all 11 subsidiaries and over 100 sales partners at www.stahlcranes.com in the Contact section.

Do you need more detailed information?

You can quickly download our extensive brochures directly onto your PC from the download section at www.stahlcranes.com.

We would however be pleased to send you the material by post too.

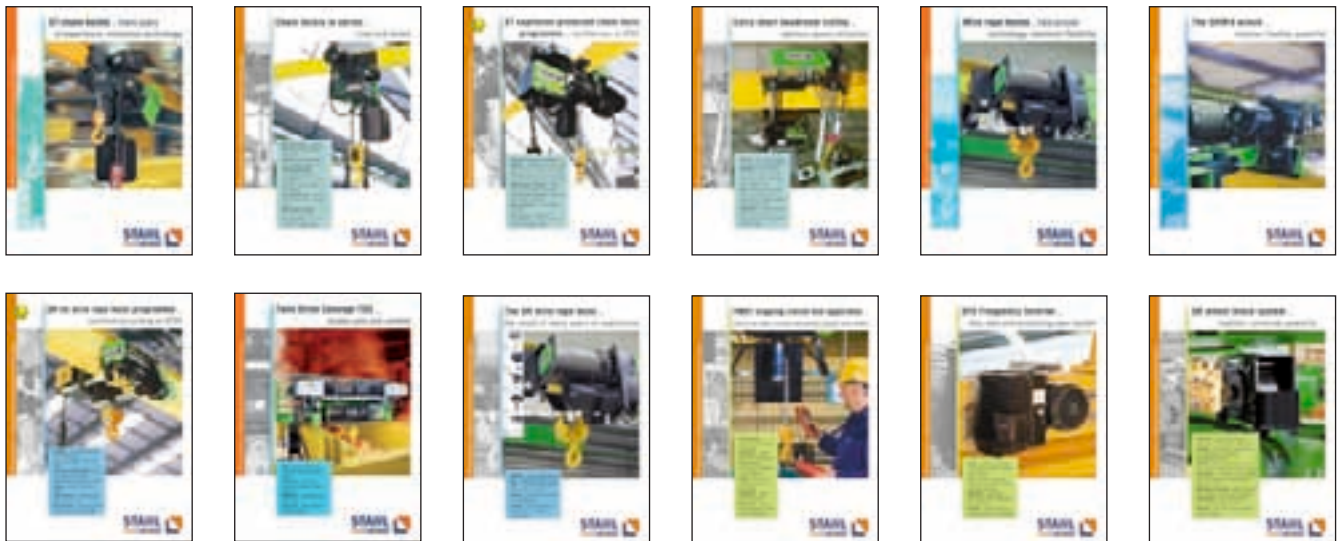

→ www.stahlcranes.com

STAHL CraneSystems GmbH, Daimlerstr. 6, 74653 Künzelsau, Germany

Tel +49 7940 128-0, Fax +49 7940 55665, marketing@stahlcranes.com

